

SECTION NO.
971-093

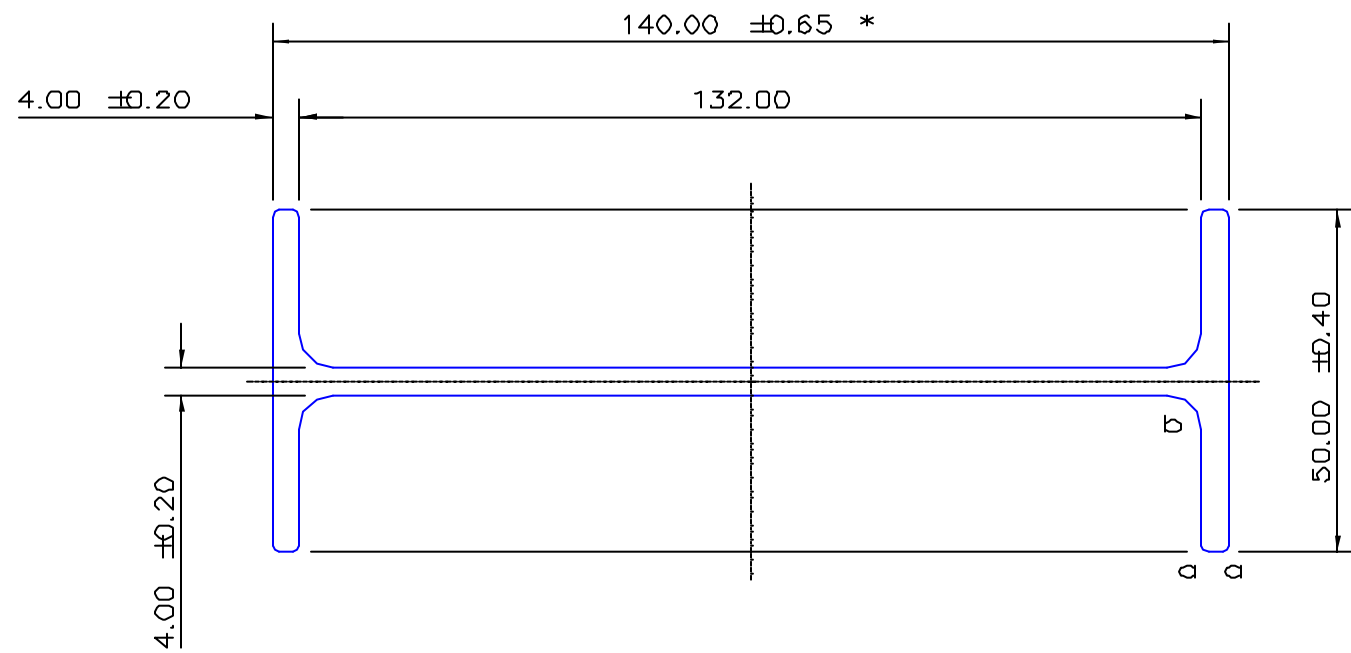

* = 1/2 STD TOLERANCE

TOTAL SURFACE EXPOSED

SECTION DATA:
 $I_{xx} = 83\,211 \text{ mm}^4$
 $I_{yy} = 2\,699\,208 \text{ mm}^4$
 Theta = 1.0
 RadGx = 9. mm
 RadGy = 53. mm
 XC_{Right} = 70.00 mm
 XC_{Left} = 70.00 mm
 YC_{Top} = 25.00 mm
 YC_{Bot} = 25.00 mm
 Z_{xTop} = 3 328 mm
 Z_{xBot} = 3 328 mm
 Z_{yRight} = 38 560 mm
 Z_{yLeft} = 38 560 mm

a = 1.00 radius
 b = 5.00 radius

0.40 RADIUS ON ALL OUTSIDE CORNERS
 UNLESS OTHERWISE SPECIFIED

EXTRUDED FINISH : ARCHITECTURAL

			AREA 947.7 SQ MM WEIGHT 2.568 KG M PERIMETER 460.0 MM ANOD PERIM 460.0 MM PAINT PERIM 460.0 (0.0) MM CIRCLE DIA 148. MM FACTOR 179. ALLOY 6063 TEMPER T6	 A.C.N 010 828 234 1082 KINGSFORD SMITH DRIVE, EAGLE FARM, QUEENSLAND, 4009 PO BOX 1376, EAGLE FARM BC, 4009 PHONE : (07) 3877 2833 FAX : (07) 3877 2890	CUSTOMER G. JAMES EXTRUSION Co.			
					CUSTOMER PART NAME NO. 140 x 50 x 4 "I" BEAM			
				SCALE 1:1	TOLERANCES IN ACCORDANCE WITH AS 1866-1986 APPLY UNLESS OTHERWISE SPECIFIED			
1	21/01/02	PAD	1/2 STD TOLERANCE ADDED		DRAWN SPG	CHECK	DATE 11/01/02	DWG. NO. 971-093
NO	DATE	DR	REVISION					