

SECTION NO.
970-108

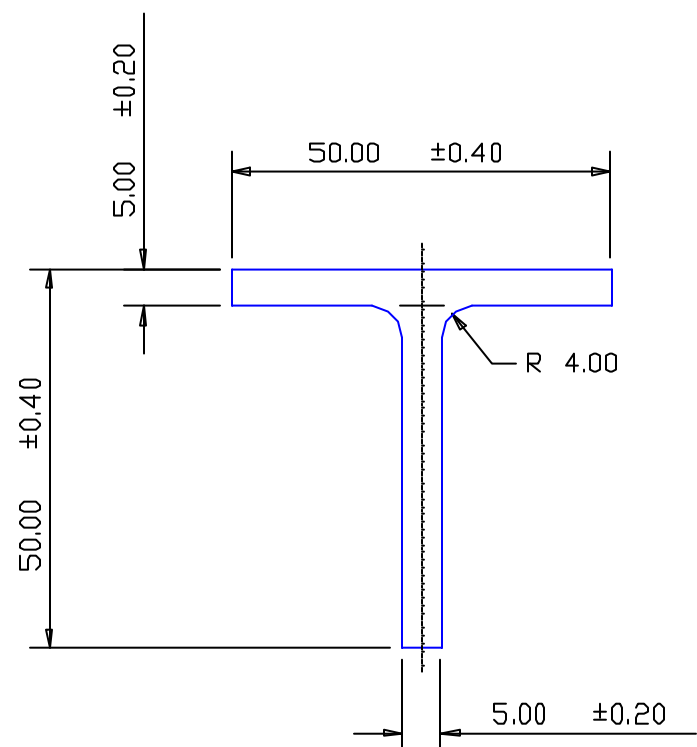

NO EXPOSED SURFACE

SECTION DATA:
 $I_{xx} = 112\,990\text{ mm}^4$
 $I_{yy} = 52\,635\text{ mm}^4$
 $\text{Theta} = 0^\circ$
 $\text{RadG}_x = 15\text{ mm}$
 $\text{RadG}_y = 10\text{ mm}$
 $\text{XC}_{\text{Right}} = 25.0\text{ mm}$
 $\text{XC}_{\text{Left}} = 25.0\text{ mm}$
 $\text{YC}_{\text{Top}} = 14.2\text{ mm}$
 $\text{YC}_{\text{Bot}} = 35.8\text{ mm}$
 $\text{Z}_{xx\text{top}} = 7\,945\text{ mm}^3$
 $\text{Z}_{xx\text{bot}} = 3\,158\text{ mm}^3$
 $\text{Z}_{yy\text{right}} = 2\,105\text{ mm}^3$
 $\text{Z}_{yy\text{left}} = 2\,105\text{ mm}^3$

0.40 RADIUS ON ALL OUTSIDE CORNERS
UNLESS OTHERWISE SPECIFIED

EXTRUDED FINISH + STRUCTURAL

			AREA 481.9 SQ MM WEIGHT 1.306 KG M PERIMETER 196.6 MM ANOD PERIM 96.6 MM PAINT PERIM 96.6 (0.0) MM C CIRCLE DIA 3 MM FACTOR 151 ALLOY 6082 TEMPER T6	 A.C.N 010 828 234 1082 KINGSFORD SMITH DRIVE, EAGLE FARM, QUEENSLAND, 4009 PO BOX 1376, EAGLE FARM BC, 4009 PHONE : (07) 3877 2833 FAX : (07) 3877 2890	CUSTOMER G. JAMES EXTRUSION Co.	
			CUSTOMER PART NAME NO. 50 x 50 x 5 TEE SECTION			
			SCALE 1:1	TOLERANCES IN ACCORDANCE WITH AS 1866-1987 APPLY UNLESS OTHERWISE SPECIFIED		
1	18/10/01	PAD	4.0 RADII ADDED AT CNRS C/N 4458	DRAWN PAD	CHECK DATE 17/09/01	DWG. NO. 970-108
NO	DATE	DR	REVISION			