

SECTION NO.
964-006

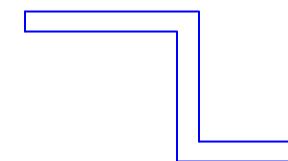
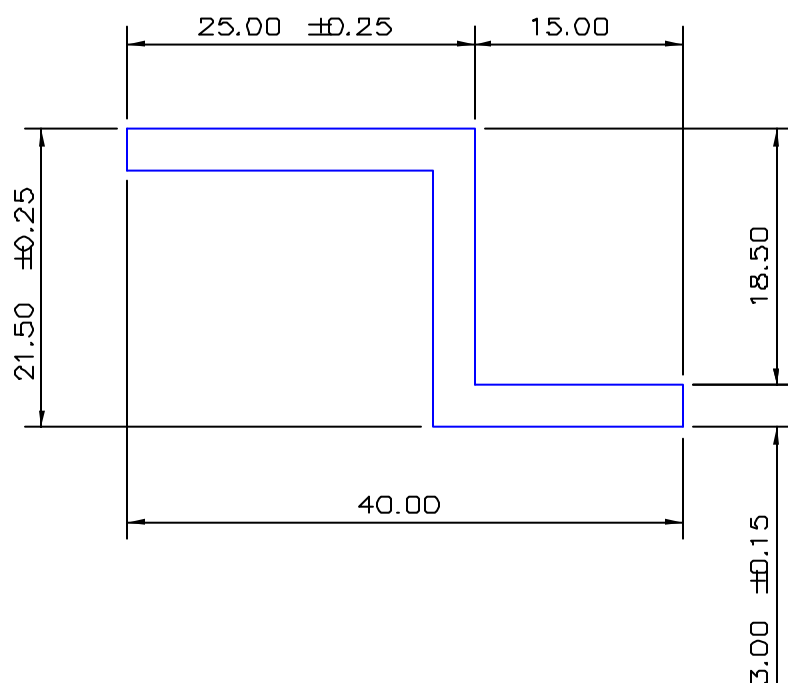

TOTAL SURFACE EXPOSED
ACTUAL SIZE

SECTION DATA:
 $I_{xx} = 11\,850\text{ mm}^4$
 $I_{yy} = 16\,506\text{ mm}^4$
 $\text{Theta} = 51$
 $\text{RadG}_x = 8\text{ mm}$
 $\text{RadG}_y = 10\text{ mm}$
 $X_{\text{Right}} = 18.9\text{ mm}$
 $X_{\text{Left}} = 21.1\text{ mm}$
 $Y_{\text{Top}} = 9.6\text{ mm}$
 $Y_{\text{Bot}} = 11.9\text{ mm}$
 $Z_{xx\text{top}} = 1\,229\text{ mm}$
 $Z_{xx\text{bot}} = 999\text{ mm}$
 $Z_{yy\text{right}} = 874\text{ mm}$
 $Z_{yy\text{left}} = 782\text{ mm}$

3.00 ±0.15 TYP WALL THICKNESS
UNLESS OTHERWISE SPECIFIED

0.40 RADIUS ON ALL OUTSIDE CORNERS
UNLESS OTHERWISE SPECIFIED

EXTRUDED FINISH : ARCHITECTURAL

			AREA	175.5	SQ MM	 <p>G. James Extrusion Co. A.C.N 010 828 234 1082 KINGSFORD SMITH DRIVE, EAGLE FARM, QUEENSLAND, 4009 PO BOX 1376, EAGLE FARM BC, 4009 PHONE : (07) 3877 2833 FAX : (07) 3877 2890</p>	CUSTOMER		G. JAMES EXTRUSION Co.	
			WEIGHT	0.476	KG M		CUSTOMER PART NAME		NØ.	
			PERIMETER	123.0	MM		'Z' SECTION			
			ANOD PERIM	123.0	MM		SCALE		TOLERANCES IN ACCORDANCE WITH AS 1866-1986 APPLY UNLESS OTHERWISE SPECIFIED	
			PAINT PERIM	123.0 (0.0)	MM		2:1			
			CIRCLE DIA	45	MM		DRAWN		DATE	
1	17/12/01	PAD	EXPOSED SURFACE ADDED C/N 4682			SPG		19/08/98		
NO	DATE	DR	REVISION			CHECK		DWG. NO.		
								964-006		