

SECTION NO.
962-050

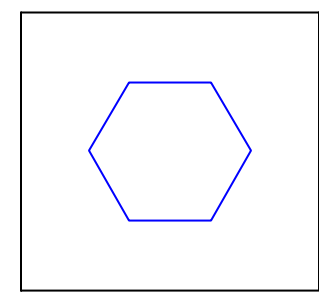
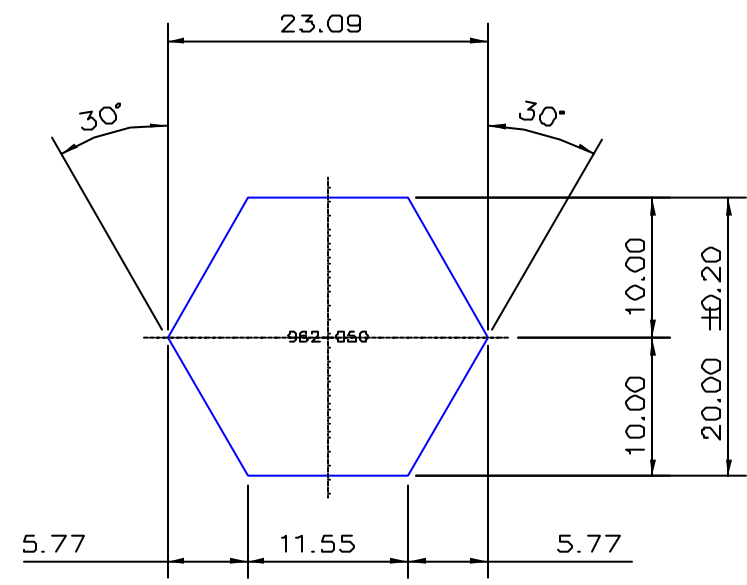

EXPOSED SURFACE
ACTUAL SIZE

SECTION DATA:
 $I_{xx} = 9\,623\text{ mm}^4$
 $I_{yy} = 9\,623\text{ mm}^4$
 $\text{Theta} = 0^\circ$
 $\text{RadG}_x = 5\text{ mm}$
 $\text{RadG}_y = 5\text{ mm}$
 $X_{\text{Right}} = 11.5\text{ mm}$
 $X_{\text{Left}} = 11.5\text{ mm}$
 $Y_{\text{Top}} = 10.0\text{ mm}$
 $Y_{\text{Bot}} = 10.0\text{ mm}$
 $Z_{xx\text{top}} = 962\text{ mm}$
 $Z_{xx\text{bot}} = 962\text{ mm}$
 $Z_{y\text{right}} = 833\text{ mm}$
 $Z_{y\text{left}} = 833\text{ mm}$

0.40 RADIUS ON ALL OUTSIDE CORNERS
UNLESS OTHERWISE SPECIFIED

EXTRUDED FINISH : STRUCTURAL

				AREA 346.4 SQ MM WEIGHT 0.939 KG M PERIMETER 69.3 MM ANOD PERIM 69.3 MM PAINT PERIM 100.0 (0.0) MM CIRCLE DIA 23 MM FACTOR 74 ALLOY 6351 TEMPER T5	 A.C.N 010 828 234 1082 KINGSFORD SMITH DRIVE, EAGLE FARM, QUEENSLAND, 4009 PO BOX 1376, EAGLE FARM BC, 4009 PHONE : (07) 3877 2833 FAX : (07) 3877 2890	CUSTOMER G. JAMES EXTRUSION Co.	
				CUSTOMER PART NAME NO. 20mm A/F HEX SOLID was HEX-020			
				SCALE 2:1		TOLERANCES IN ACCORDANCE WITH AS 1866-1986 APPLY UNLESS OTHERWISE SPECIFIED	
NO	DATE	DR	REVISION	DRAWN A.T. CHECK DATE 08/04/87 DWG. NO. 962-050			