

SECTION NO.
960-200

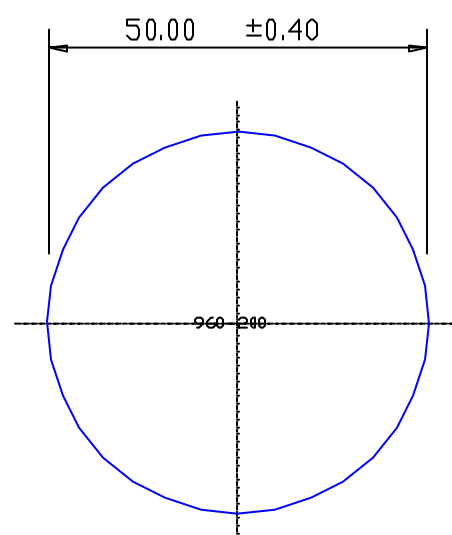

TOTAL SURFACE EXPOSED

SECTION DATA:

$I_{xx} = 306\,796 \text{ mm}^4$
 $I_{yy} = 306\,796 \text{ mm}^4$
 $\text{Theta} = 1.0^\circ$
 $\text{RadG}_x = 13. \text{ mm}$
 $\text{RadG}_y = 13. \text{ mm}$
 $\text{XC}_{\text{Right}} = 25.0 \text{ mm}$
 $\text{XC}_{\text{Left}} = 25.0 \text{ mm}$
 $\text{YC}_{\text{top}} = 25.0 \text{ mm}$
 $\text{YC}_{\text{bot}} = 25.0 \text{ mm}$
 $Z_{xx\text{top}} = 12\,272 \text{ mm}^3$
 $Z_{xx\text{bot}} = 12\,272 \text{ mm}^3$
 $Z_{yy\text{right}} = 12\,272 \text{ mm}^3$
 $Z_{yy\text{left}} = 12\,272 \text{ mm}^3$

0.40 RADIUS ON ALL OUTSIDE CORNERS
UNLESS OTHERWISE SPECIFIED

EXTRUDED FINISH : ARCHITECTURAL

			AREA 1963.5 SQ MM WEIGHT 5.321 KG M PERIMETER 157.1 MM ANOD PERIM 157.1 MM PAINT PERIM 157.1 (0.0) MM C CIRCLE DIA 50.0 MM FACTOR 30. ALLOY 6063 TEMPER T5	 <p> A.C.N 010 828 234 1082 KINGSFORD SMITH DRIVE, EAGLE FARM, QUEENSLAND, 4009 PO BOX 1376, EAGLE FARM BC, 4009 PHONE : (07) 3877 2833 FAX : (07) 3877 2890 </p>	CUSTOMER G. JAMES EXTRUSION Co.				
					CUSTOMER PART NAME NO. 50mm SOLID ROUND		SCALE 1:1		TOLERANCES IN ACCORDANCE WITH AS 1866-1986 APPLY UNLESS OTHERWISE SPECIFIED
NO	DATE	DR	REVISION		DRAWN A.T	CHECK	DATE 12/12/86	DWG. NO. 960-200	