

SECTION NO.
960-035

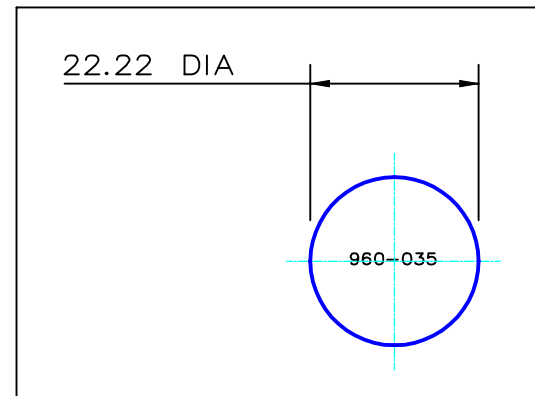

TOTAL SURFACE EXPOSED

SECTION DATA:
 $I_{xx} = 11\,977 \text{ mm}^4$
 $I_{yy} = 11\,977 \text{ mm}^4$
 Theta = 1.0
 RadG_x = 6. mm
 RadG_y = 6. mm
 X_{Right} = 11.1 mm
 X_{Left} = 11.1 mm
 Y_{Top} = 11.1 mm
 Y_{Bot} = 11.1 mm
 Z_{xx}top = 1.078 mm³
 Z_{xx}bot = 1.078 mm³
 Z_{yy}right = 1.078 mm³
 Z_{yy}left = 1.078 mm³

0.40 RADIUS ON ALL OUTSIDE CORNERS
UNLESS OTHERWISE SPECIFIED

EXTRUDED FINISH : ARCHITECTURAL

			AREA 387.9 SQ MM WEIGHT 1.051 KG M PERIMETER 69.8 MM ANOD PERIM 69.8 MM PAINT PERIM 100.0 MM C CIRCLE DIA 22. MM FACTOR 66. ALLOY 6063 TEMPER T5	 <p>A.C.N 010 828 234 1082 KINGSFORD SMITH DRIVE, EAGLE FARM, QUEENSLAND, 4009 PO BOX 1376, EAGLE FARM BC, 4009 PHONE : (07) 3877 2833 FAX : (07) 3877 2890</p>	CUSTOMER G. JAMES EXTRUSION Co.		
			CUSTOMER PART NAME NO. ? 22.22 SOLID ROUND				
			SCALE 1:1		TOLERANCES IN ACCORDANCE WITH AS 1866-1986 APPLY UNLESS OTHERWISE SPECIFIED		
NO	DATE	DR	REVISION	DRAWN BPW	CHECK	DATE 08/01/90	DWG. NO. 960-035