

SECTION NO.
941-247

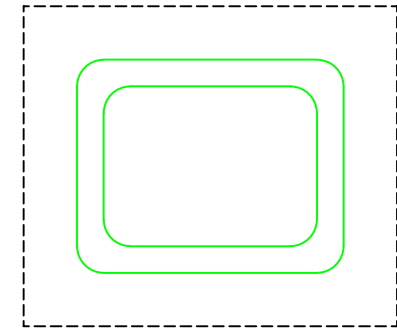
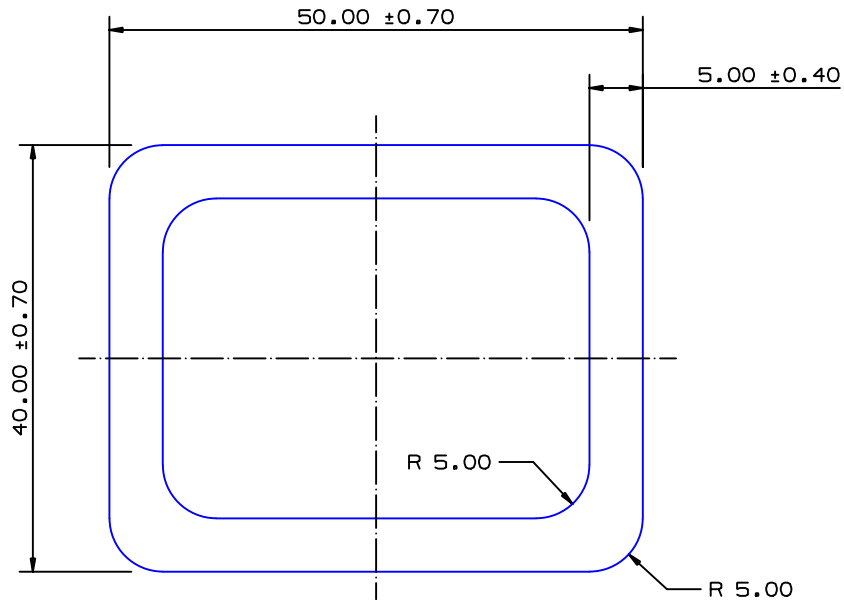

SECTION DATA:
 $I_{xx} = 173\ 151\ \text{mm}^4$
 $I_{yy} = 252\ 078\ \text{mm}^4$
 $\text{Theta} = 1.0^\circ$
 $\text{RadG}_x = 15\ \text{mm}$
 $\text{RadG}_y = 18\ \text{mm}$
 $\text{XC}_{\text{Right}} = 25.0\ \text{mm}$
 $\text{XC}_{\text{Left}} = 25.0\ \text{mm}$
 $\text{YC}_{\text{Top}} = 20.0\ \text{mm}$
 $\text{YC}_{\text{Bot}} = 20.0\ \text{mm}$
 $Z_{xx\text{Top}} = 8\ 658\ \text{mm}^3$
 $Z_{xx\text{Bot}} = 8\ 658\ \text{mm}^3$
 $Z_{yy\text{Right}} = 10\ 083\ \text{mm}^3$
 $Z_{yy\text{Left}} = 10\ 083\ \text{mm}^3$

5.00±0.40 TYP WALL THICKNESS
UNLESS OTHERWISE SPECIFIED

0.40 RADIUS ON ALL OUTSIDE CORNERS
UNLESS OTHERWISE SPECIFIED

EXTRUDED FINISH : STRUCTURAL

			A 40341		AREA 800.0 SQ MM	 <p>G. James Extrusion Co.</p> <p>A.C.N 010 828 234 1082 KINGSFORD SMITH DRIVE, EAGLE FARM, QUEENSLAND, 4009 PO BOX 1376, EAGLE FARM BC, 4009 PHONE : (07) 3877 2633 FAX : (07) 3877 2690</p>	CUSTOMER G. JAMES EXTRUSION Co.	
					WEIGHT 2.168 KG M		CUSTOMER PART NAME NO. 50 x 40 x 5 RECT BOX R/CNRS	
					PERIMETER 302.8 MM		SCALE 2:1	
					ANOD PERIM 171.4 MM		TOLERANCES IN ACCORDANCE WITH AS 1886-1986 APPLY UNLESS OTHERWISE SPECIFIED	
					PAINT PERIM 171.4 (0.0) MM		DRAWN CHECK DATE DWG. NO. SPG 17/03/04 941-247	
					C CIRCLE DIA 60 MM			
					FACTOR 140			
NO	DATE	DR	REVISION		ALLOY NV6082			
					TEMPER T6			