

SECTION NO.
940-089

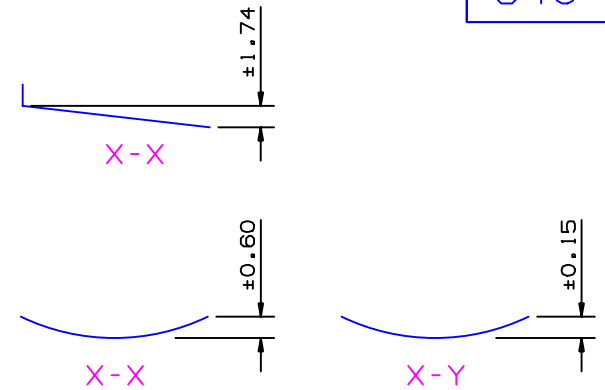
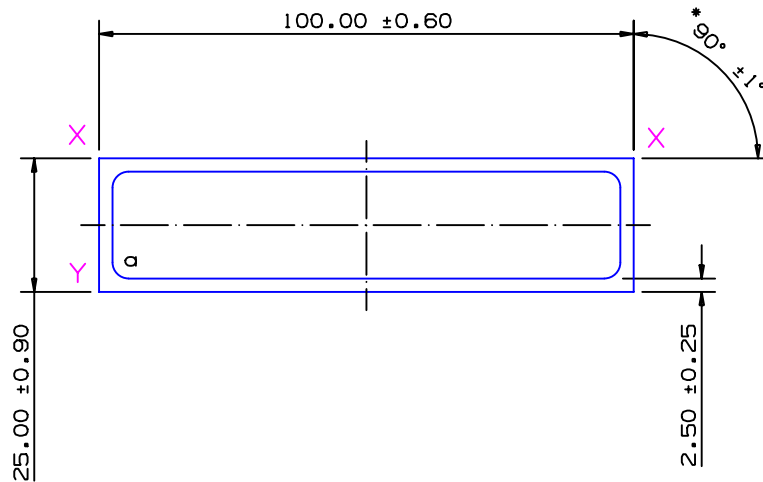

THIS SECTION IS SUITABLE FOR NV6082 T6 APPLICATIONS FOR SYDNEY PRESS ONLY

* = 1/2 STANDARD TOLERANCE

TOTAL SURFACE EXPOSED

SECTION DATA:

$I_{xx} = 67\,550\text{ mm}^4$
 $I_{yy} = 671\,320\text{ mm}^4$
 $\text{Theta} = 1.0^\circ$
 $\text{RadG}_x = 11\text{ mm}$
 $\text{RadG}_y = 33\text{ mm}$
 $\text{XC}_{\text{Right}} = 50.00\text{ mm}$
 $\text{XC}_{\text{Left}} = 50.00\text{ mm}$
 $\text{YC}_{\text{top}} = 12.50\text{ mm}$
 $\text{YC}_{\text{bot}} = 12.50\text{ mm}$
 $\text{Z}_{\text{xx}_{\text{top}}} = 5\,404\text{ mm}^3$
 $\text{Z}_{\text{xx}_{\text{bot}}} = 5\,404\text{ mm}^3$
 $\text{Z}_{\text{yy}_{\text{right}}} = 13\,426\text{ mm}^3$
 $\text{Z}_{\text{yy}_{\text{left}}} = 13\,426\text{ mm}^3$

$a = 3.00\text{ radius}$

2.50±0.25 TYP WALL THICKNESS
UNLESS OTHERWISE SPECIFIED

0.40 RADIUS ON ALL OUTSIDE CORNERS
UNLESS OTHERWISE SPECIFIED

EXTRUDED FINISH : STRUCTURAL

				A		AREA 607.7 SQ MM WEIGHT 1.647 KG M PERIMETER 474.8 MM ANOD PERIM 250.0 MM PAINT PERIM 250.0 (0.0) MM CIRCLE DIA 103 MM FACTOR 288 ALLOY 6082 TEMPER T6	 © COPYRIGHT 2004 THIS DRAWING IS THE PROPERTY OF G. JAMES EXTRUSION CO. PTY LTD ALL RIGHTS RESERVED A.C.N 010 828 234 1082 KINGSFORD SMITH DRIVE, EAGLE FARM, QUEENSLAND, 4009 PO BOX 1376, EAGLE FARM BC, 4009 PHONE : (07) 3877 2833 FAX : (07) 3877 2890	CUSTOMER G. JAMES EXTRUSION Co.	
						CUSTOMER PART NAME NO. 100 x 25 x 2.50 RECT. BOX			
						SCALE 1 : 1		TOLERANCES IN ACCORDANCE WITH AS/NZS 1866:1997 APPLY UNLESS OTHERWISE SPECIFIED	
						DRAWN SPG		CHECK DATE 05/11/99	
						DWG. NO. 940-089			
1	16/03/12	SPG	'DNV' NOTE ADDED C/N 9197						
NO	DATE	DR	REVISION						