

SECTION NO.  
940-087

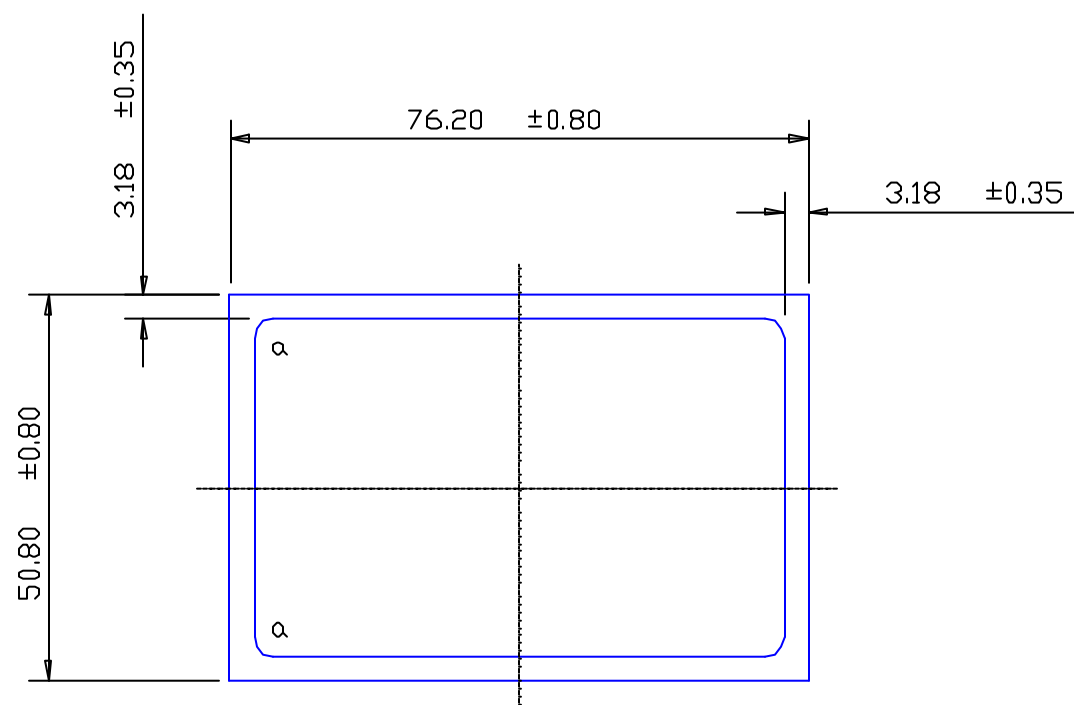

TOTAL SURFACE EXPOSED

SECTION DATA:  
 $I_{xx} = 324\,388\text{ mm}^4$   
 $I_{yy} = 618\,332\text{ mm}^4$   
 $\text{Theta} = 1.0^\circ$   
 $\text{RadG}_x = 20\text{ mm}$   
 $\text{RadG}_y = 28\text{ mm}$   
 $\text{XC}_{\text{Right}} = 38.10\text{ mm}$   
 $\text{XC}_{\text{Left}} = 38.10\text{ mm}$   
 $\text{YC}_{\text{top}} = 25.40\text{ mm}$   
 $\text{YC}_{\text{bot}} = 25.40\text{ mm}$   
 $\text{Z}_{xx\text{top}} = 12\,771\text{ mm}^3$   
 $\text{Z}_{xx\text{bot}} = 12\,771\text{ mm}^3$   
 $\text{Z}_{yy\text{right}} = 16\,229\text{ mm}^3$   
 $\text{Z}_{yy\text{left}} = 16\,229\text{ mm}^3$

$a = 2.60\text{ radius}$

3.18±0.35 TYP WALL THICKNESS  
UNLESS OTHERWISE SPECIFIED

0.40 RADIUS ON ALL OUTSIDE CORNERS  
UNLESS OTHERWISE SPECIFIED

EXTRUDED FINISH + STRUCTURAL

			A		AREA	773.1	SQ MM	 G. James Extrusion Co. A.C.N 010 828 234 1082 KINGSFORD SMITH DRIVE, EAGLE FARM, QUEENSLAND, 4009 PO BOX 1376, EAGLE FARM BC, 4009 PHONE : (07) 3877 2833 FAX : (07) 3877 2890	CUSTOMER		G. JAMES EXTRUSION Co.		
					WEIGHT	2.095	KG M		CUSTOMER PART NAME		NO.		
					PERIMETER	478.1	MM		76.2 x 50.8 x 3.18 RECT. BOX				
					ANOD PERIM	254.0	MM		SCALE		TOLERANCES IN ACCORDANCE WITH AS 1866-1987		
					PAINT PERIM	254.0 (0.0)	MM		1:1		APPLY UNLESS OTHERWISE SPECIFIED		
					C CIRCLE DIA	92	MM		DRAWN		CHECK	DATE	DWG. NO.
					FACTOR	228			SPG			24/08/01	940-087
2	18/11/03	PAD	NV6082 T6 WERE 6060 T5; 2.6 RADS ADDED C/N		ALLOY	NV6082							
1	10/09/01	PAD	SECTION NO. WAS SMA-061		TEMPER	T6							
NO	DATE	DR	REVISION										