

SECTION NO.  
921-090

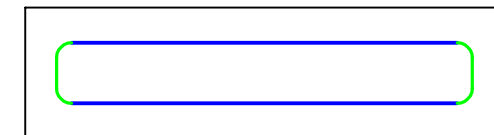
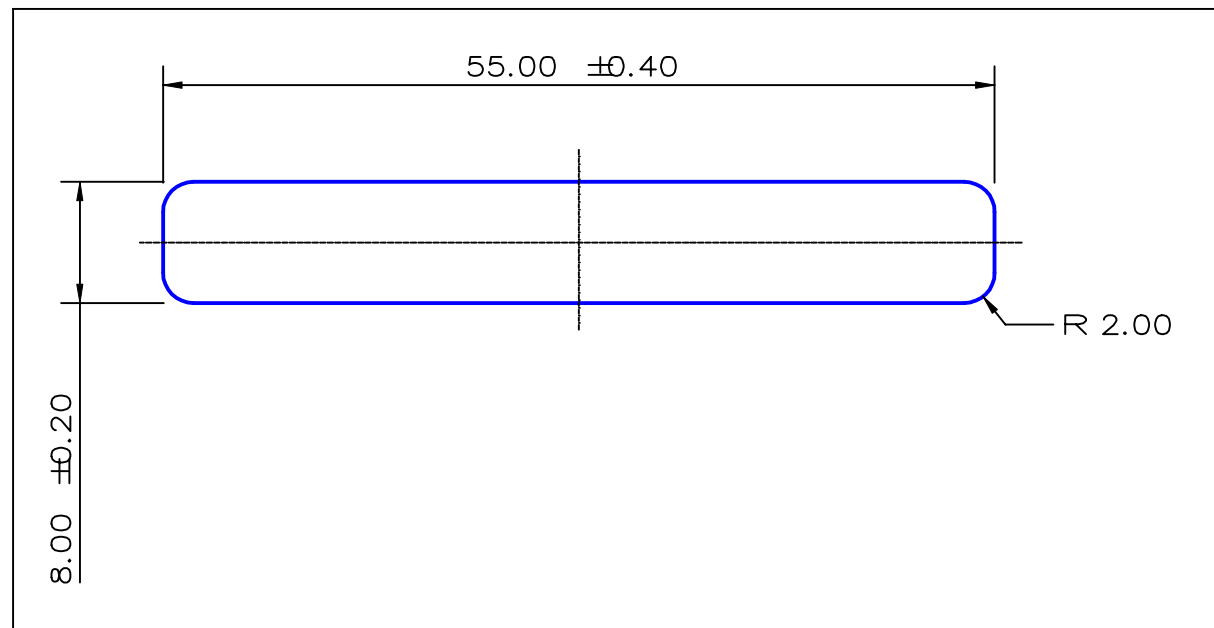

ACTUAL SIZE  
TOTAL SURFACE EXPOSED

SECTION DATA:  
 $I_{xx} = 2\,303 \text{ mm}^4$   
 $I_{yy} = 108\,403 \text{ mm}^4$   
 $\text{Theta} = 1.0$   
 $\text{RadG}_x = 2. \text{ mm}$   
 $\text{RadG}_y = 16. \text{ mm}$   
 $\text{XC}_{\text{Right}} = 27.5 \text{ mm}$   
 $\text{XC}_{\text{Left}} = 27.5 \text{ mm}$   
 $\text{YC}_{\text{top}} = 4.0 \text{ mm}$   
 $\text{YC}_{\text{bot}} = 4.0 \text{ mm}$   
 $Z_{xx\text{top}} = 576 \text{ mm}^3$   
 $Z_{xx\text{bot}} = 576 \text{ mm}^3$   
 $Z_{yy\text{right}} = 3\,942 \text{ mm}^3$   
 $Z_{yy\text{left}} = 3\,942 \text{ mm}^3$

0.40 RADIUS ON ALL OUTSIDE CORNERS  
UNLESS OTHERWISE SPECIFIED

EXTRUDED FINISH : ARCHITECTURAL

1	14/09/00	SPG	55.0 8.0 WERE 50.0 10.0	AREA	436.6	SQ MM
				WEIGHT	1.183	KG M
				PERIMETER	122.6	MM
				ANOD PERIM	122.6	MM
				PAINT PERIM	122.6 (0.0)	MM
				C CIRCLE DIA	55.	MM
				FACTOR	104.	
				ALLOY	6060HE	
				TEMPER	T5	



A.C.N 010 828 234  
 1082 KINGSFORD SMITH DRIVE, EAGLE FARM, QUEENSLAND, 4009  
 PO BOX 1376, EAGLE FARM BC, 4009  
 PHONE : (07) 3877 2833 FAX : (07) 3877 2890

CUSTOMER			
G. JAMES EXTRUSION Co.			
CUSTOMER PART NAME		NO.	
55 x 8 FLAT BAR - RAD CNRS			
SCALE		TOLERANCES IN ACCORDANCE WITH AS 1866-1986 APPLY UNLESS OTHERWISE SPECIFIED	
2:1			
DRAWN	CHECK	DATE	DWG. NO.
SPG		29/08/00	921-090