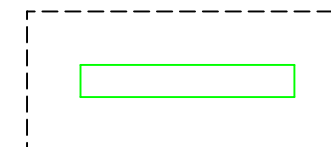
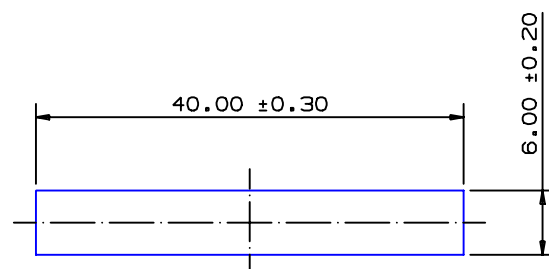

SECTION NO.

920-080

EXPOSED SURFACE
ACTUAL SIZETHIS SECTION IS SUITABLE FOR NV6082 T6
APPLICATIONS FOR SYDNEY PRESS ONLY

SECTION DATA:

$I_{xx} = 720 \text{ mm}^4$
 $I_{yy} = 32\,000 \text{ mm}^4$
 $\text{Theta} = 1.0^\circ$
 $\text{RadG}_x = 2 \text{ mm}$
 $\text{RadG}_y = 12 \text{ mm}$
 $\text{XC}_{\text{Right}} = 20.0 \text{ mm}$
 $\text{XC}_{\text{Left}} = 20.0 \text{ mm}$
 $\text{YC}_{\text{top}} = 3.0 \text{ mm}$
 $\text{YC}_{\text{bot}} = 3.0 \text{ mm}$
 $\text{Z}_{\text{xx, top}} = 240 \text{ mm}^3$
 $\text{Z}_{\text{xx, bot}} = 240 \text{ mm}^3$
 $\text{Z}_{\text{yy, right}} = 1\,600 \text{ mm}^3$
 $\text{Z}_{\text{yy, left}} = 1\,600 \text{ mm}^3$

0.40 RADIUS ON ALL OUTSIDE CORNERS
UNLESS OTHERWISE SPECIFIED

EXTRUDED FINISH : ARCHITECTURAL

				AREA 240.0 SQ MM WEIGHT 0.650 KG M PERIMETER 92.0 MM ANOD PERIM 92.0 MM PAINT PERIM 100.0 (0.0) MM C CIRCLE DIA 40 MM FACTOR 141 ALLOY 6063 TEMPER T6	 © COPYRIGHT 2004 THIS DRAWING IS THE PROPERTY OF G. JAMES EXTRUSION CO. PTY LTD ALL RIGHTS RESERVED A.C.N 010 828 234 1082 KINGSFORD SMITH DRIVE, EAGLE FARM, QUEENSLAND, 4009 PO BOX 1376, EAGLE FARM BC, 4009 PHONE : (07) 3877 2833 FAX : (07) 3877 2890	CUSTOMER G. JAMES EXTRUSION Co.			
						CUSTOMER PART NAME NO. 40 x 6 FLAT BAR			
						SCALE 2:1	TOLERANCES IN ACCORDANCE WITH AS/NZS 1866:1997 APPLY UNLESS OTHERWISE SPECIFIED		
1	30/11/11	SP6	'DNV' NOTE ADDED C/N 9077			DRAWN A.T.	CHECK	DATE 06/03/87	DWG. NO. 920-080
NO	DATE	DR	REVISION						