

SECTION NO.  
950-350

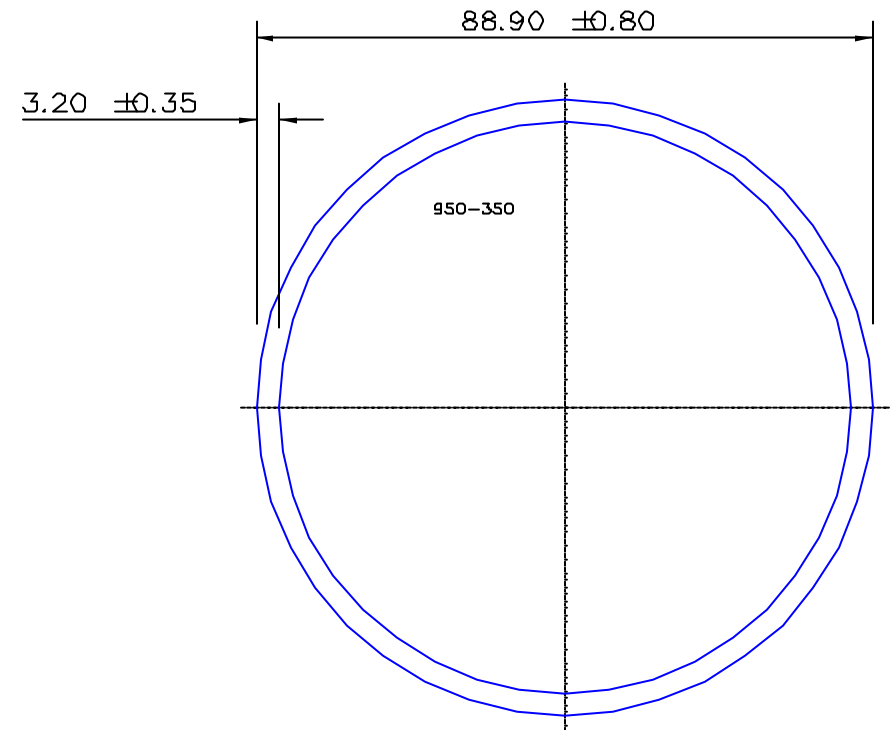

TOTAL SURFACE EXPOSED

SECTION DATA:  
 $I_{xx} = 792\,059 \text{ mm}^4$   
 $I_{yy} = 792\,059 \text{ mm}^4$   
 $\text{Theta} = 1.0$   
 $\text{RadG}_x = 30. \text{ mm}$   
 $\text{RadG}_y = 30. \text{ mm}$   
 $X_{C_{\text{right}}} = 44.5 \text{ mm}$   
 $X_{C_{\text{left}}} = 44.5 \text{ mm}$   
 $Y_{C_{\text{top}}} = 44.5 \text{ mm}$   
 $Y_{C_{\text{bot}}} = 44.5 \text{ mm}$   
 $Z_{xx_{\text{top}}} = 17\,819 \text{ mm}$   
 $Z_{xx_{\text{bot}}} = 17\,819 \text{ mm}$   
 $Z_{yy_{\text{right}}} = 17\,819 \text{ mm}$   
 $Z_{yy_{\text{left}}} = 17\,819 \text{ mm}$

0.40 RADIUS ON ALL OUTSIDE CORNERS  
UNLESS OTHERWISE SPECIFIED

EXTRUDED FINISH : ARCHITECTURAL

			<p>A</p>		<p>AREA 861.6 SQ MM</p> <p>WEIGHT 2.335 KG M</p> <p>PERIMETER 538.5 MM</p> <p>ANOD PERIM 279.3 MM</p> <p>PAINT PERIM 279.3 (0.0) MM</p> <p>C CIRCLE DIA 89. MM</p> <p>FACTOR 231.</p> <p>ALLOY 6351</p> <p>TEMPER T6</p>	 <p>G. James Extrusion Co.</p> <p>A.C.N 010 828 234</p> <p>1082 KINGSFORD SMITH DRIVE, EAGLE FARM, QUEENSLAND, 4009</p> <p>PO BOX 1376, EAGLE FARM BC, 4009</p> <p>PHONE : (07) 3877 2833 FAX : (07) 3877 2890</p>	<p>CUSTOMER</p> <p>G. JAMES EXTRUSION Co.</p>		
NO	DATE	DR	REVISION		<p>CUSTOMER PART NAME NO.</p> <p>88.9 DIA x 3.2 ROUND TUBE</p>		<p>SCALE</p> <p>1:1</p>	<p>TOLERANCES IN ACCORDANCE WITH AS 1866-1986</p> <p>APPLY UNLESS OTHERWISE SPECIFIED</p>	
						<p>DRAWN</p> <p>PAD</p>	<p>CHECK</p>	<p>DATE</p> <p>13/09/01</p>	<p>DWG. NO.</p> <p>950-350</p>