

SECTION NO.
950-298

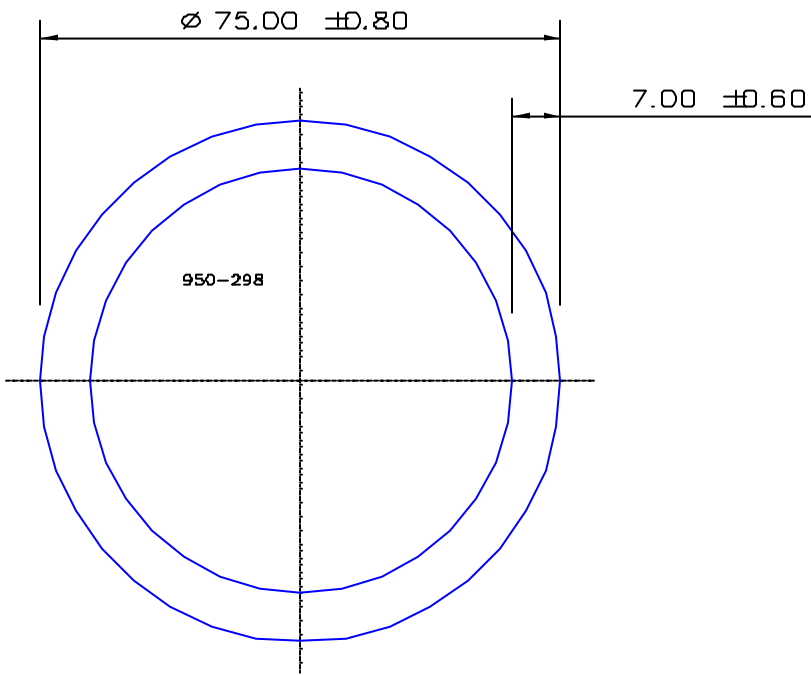

NO EXPOSED SURFACE

SECTION DATA:
 $I_{xx} = 873\,499 \text{ mm}^4$
 $I_{yy} = 873\,499 \text{ mm}^4$
 $\text{Theta} = 1.0^\circ$
 $\text{RadG}_x = 24. \text{ mm}$
 $\text{RadG}_y = 24. \text{ mm}$
 $X_{C_{\text{right}}} = 37.5 \text{ mm}$
 $X_{C_{\text{left}}} = 37.5 \text{ mm}$
 $Y_{C_{\text{top}}} = 37.5 \text{ mm}$
 $Y_{C_{\text{bot}}} = 37.5 \text{ mm}$
 $Z_{x_{\text{top}}} = 23\,293 \text{ mm}$
 $Z_{x_{\text{bot}}} = 23\,293 \text{ mm}$
 $Z_{y_{\text{right}}} = 23\,293 \text{ mm}$
 $Z_{y_{\text{left}}} = 23\,293 \text{ mm}$

0.40 RADIUS ON ALL OUTSIDE CORNERS
UNLESS OTHERWISE SPECIFIED

EXTRUDED FINISH : STRUCTURAL

			A		AREA	1495.4	SQ MM	 G. James Extrusion Co. A.C.N 010 828 234 1082 KINGSFORD SMITH DRIVE, EAGLE FARM, QUEENSLAND, 4009 PO BOX 1376, EAGLE FARM BC, 4009 PHONE : (07) 3877 2833 FAX : (07) 3877 2890	CUSTOMER		G. JAMES EXTRUSION Co.		
					WEIGHT	4.053	KG M		CUSTOMER PART NAME		75.0 DIA x 7.0 ROUND TUBE		
					PERIMETER	427.3	MM		SCALE		1:1		
					ANOD PERIM	235.6	MM		TOLERANCES IN ACCORDANCE WITH AS 1866-1986		APPLY UNLESS OTHERWISE SPECIFIED		
					PAINT PERIM	235.6 (0.0)	MM		DRAWN		CHECK	DATE	DWG. NO.
					CIRCLE DIA	75.	MM		SPG			24/08/01	950-298
1	10/09/01	PAD	SECTION NO. WAS SMA-060		FACTOR	105.							
NO	DATE	DR	REVISION		ALLOY	6351							
					TEMPER	T5							