

SECTION NO.
950-226

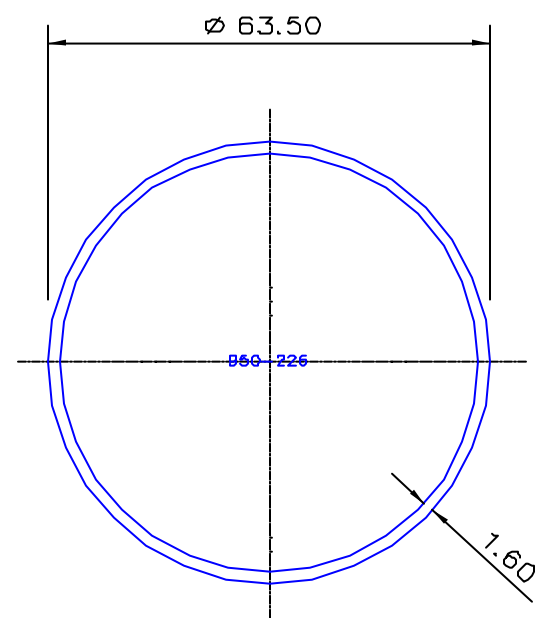

TOTAL SURFACE EXPOSED

SECTION DATA:
 $I_{xx} = 149\,122 \text{ mm}^4$
 $I_{yy} = 149\,122 \text{ mm}^4$
 Theta = 1.0
 RadGx = 22. mm
 RadGy = 22. mm
 XCleft = 31.8 mm
 XCright = 31.8 mm
 YCtop = 31.8 mm
 YCbot = 31.8 mm
 $Z_{xx\text{top}} = 4\,697 \text{ mm}$
 $Z_{xx\text{bot}} = 4\,697 \text{ mm}$
 $Z_{yy\text{left}} = 4\,697 \text{ mm}$
 $Z_{yy\text{right}} = 4\,697 \text{ mm}$

0.40 RADIUS ON ALL OUTSIDE CORNERS
UNLESS OTHERWISE SPECIFIED

EXTRUDED FINISH : ARCHITECTURAL

| | | | | | | | | |
|----|------|----|----------|---|---|---|--|--|
| | | | A | AREA 311.1 SQ MM WEIGHT 0.843 KG M PERIMETER 388.9 MM ANOD PERIM 199.5 MM PAINT PERIM 199.5 MM CIRCLE DIA 64. MM FACTOR 461. ALLOY 6063 TEMPER T6 |  A.C.N 010 828 234 1082 KINGSFORD SMITH DRIVE, EAGLE FARM, QUEENSLAND, 4009 PO BOX 1376, EAGLE FARM BC, 4009 PHONE : (07) 3877 2833 FAX : (07) 3877 2890 | CUSTOMER G. JAMES EXTRUSION Co. CUSTOMER PART NAME NO. 63.5 x 1.6 ROUND TUBE | SCALE 1:1 TOLERANCES IN ACCORDANCE WITH AS 1866-1986 APPLY UNLESS OTHERWISE SPECIFIED | DRAWN SPG CHECK DATE 07/09/94 DWG. NO. 950-226 |
| NO | DATE | DR | REVISION | | | | | |