

**246 SERIES 5-TRACK SLIDING DOOR (168mm FRAME)**  
**CLAD WALL CONSTRUCTION - FIBRE CEMENT SHEET & STUD WALL**

1 of 3

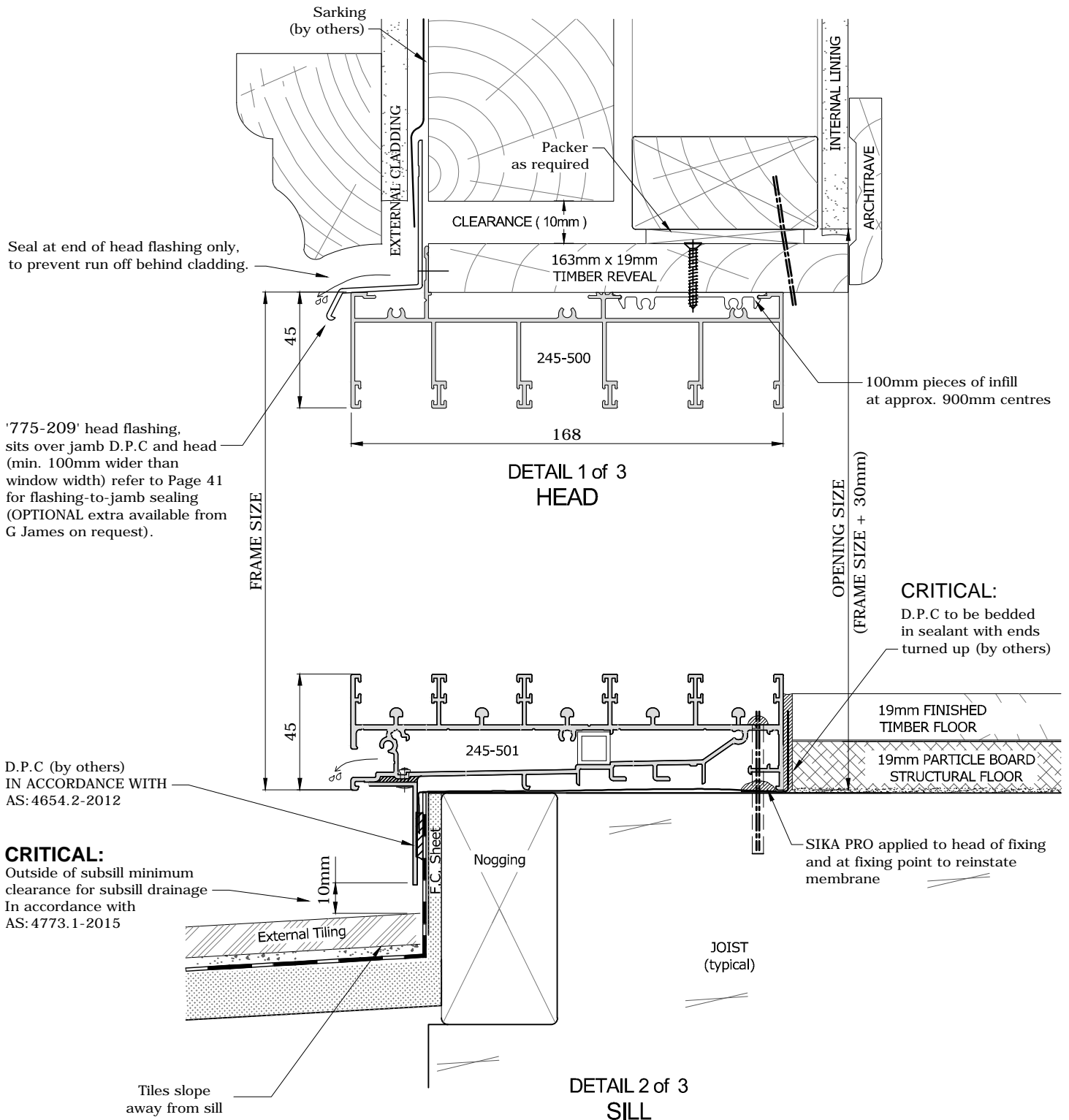

Fixings shown are for illustration purposes only. All fixings to be assessed by a G.James Engineer to suit the design criteria of the project. Sill must be level side-to-side, front-to-back, and supported at fixing points.

**246 SERIES 5-TRACK SLIDING DOOR (168mm FRAME)  
CLAD WALL CONSTRUCTION - FIBRE CEMENT SHEET & STUD WALL**

2 of 3

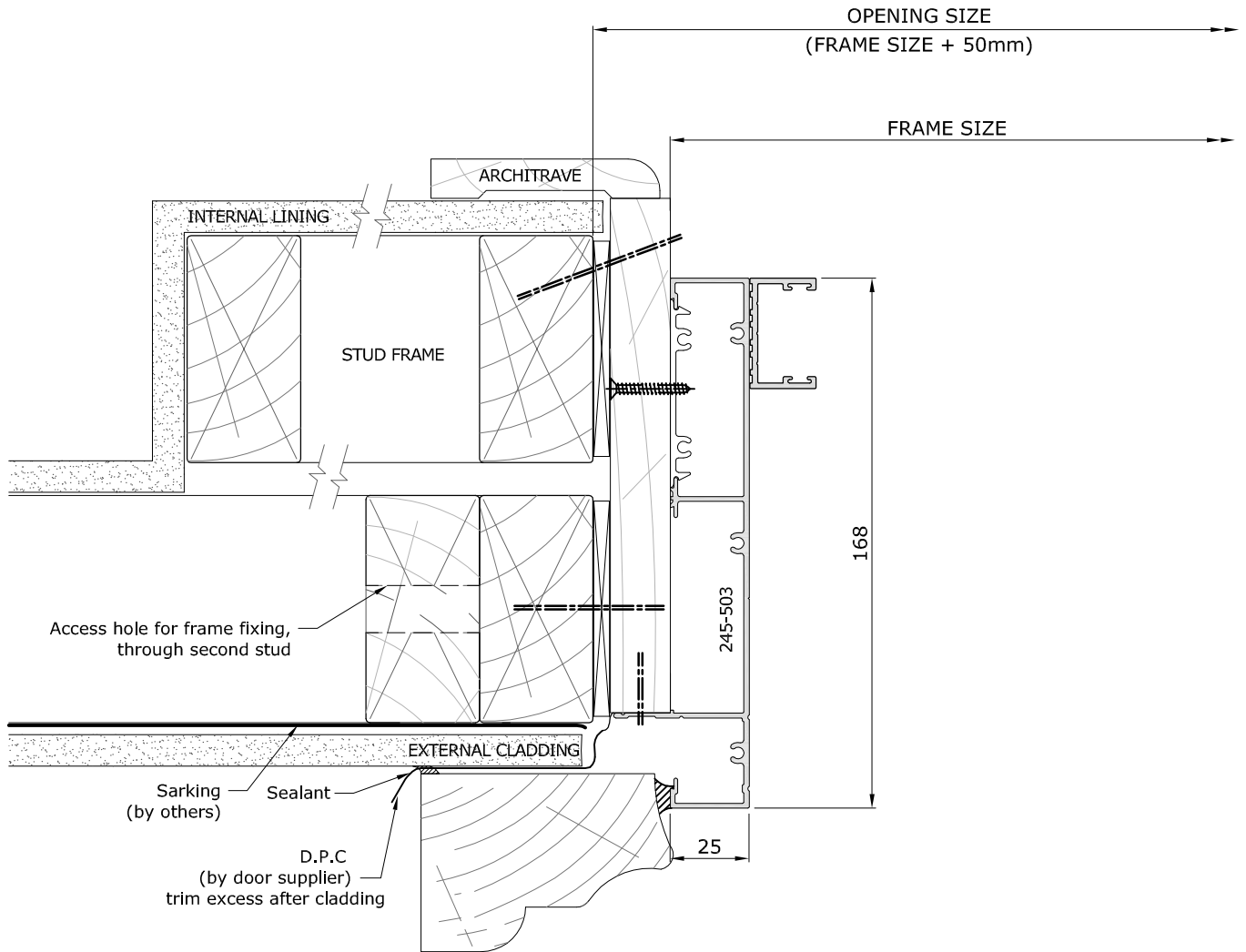

**DETAIL 3 of 3  
JAMB**

▷ Fixings shown are for illustration purposes only. All fixings to be assessed by a G.James Engineer to suit the design criteria of the project.

**246 SERIES 5-TRACK SLIDING DOOR (168mm FRAME)  
CLAD WALL CONSTRUCTION - FIBRE CEMENT SHEET & STUD WALL (ALT.)**

3 of 3

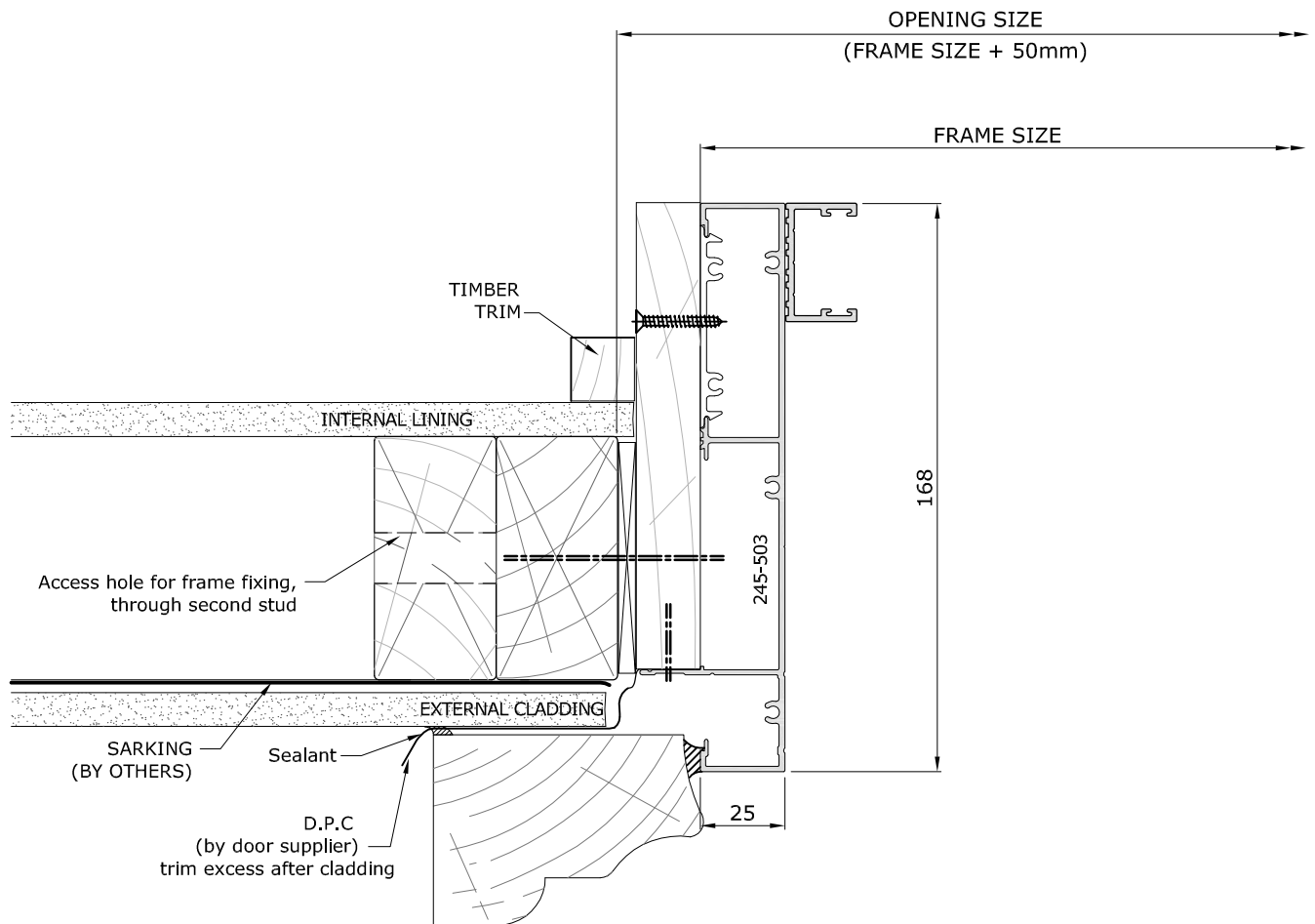

**DETAIL 3 of 3  
JAMB (ALT.)**

▷ Fixings shown are for illustration purposes only. All fixings to be assessed by a G.James Engineer to suit the design criteria of the project.

**246 SERIES 5-TRACK SLIDING DOOR (101mm FRAME)  
CLAD WALL CONSTRUCTION - FIBRE CEMENT SHEET - FLASHING DETAIL**

