

**5-TRACK SLIDING DOOR - (246 SERIES FRAME, 247 INTERNALS)
FLUSH SILL TRANSITION WITH BUZON PEDESTAL SYSTEM**

1 of 1

CRITICAL:

- Outside of sill must not be sealed or blocked by external finishes.
- Area under the sill must be allowed to freely drain + pressure equalise

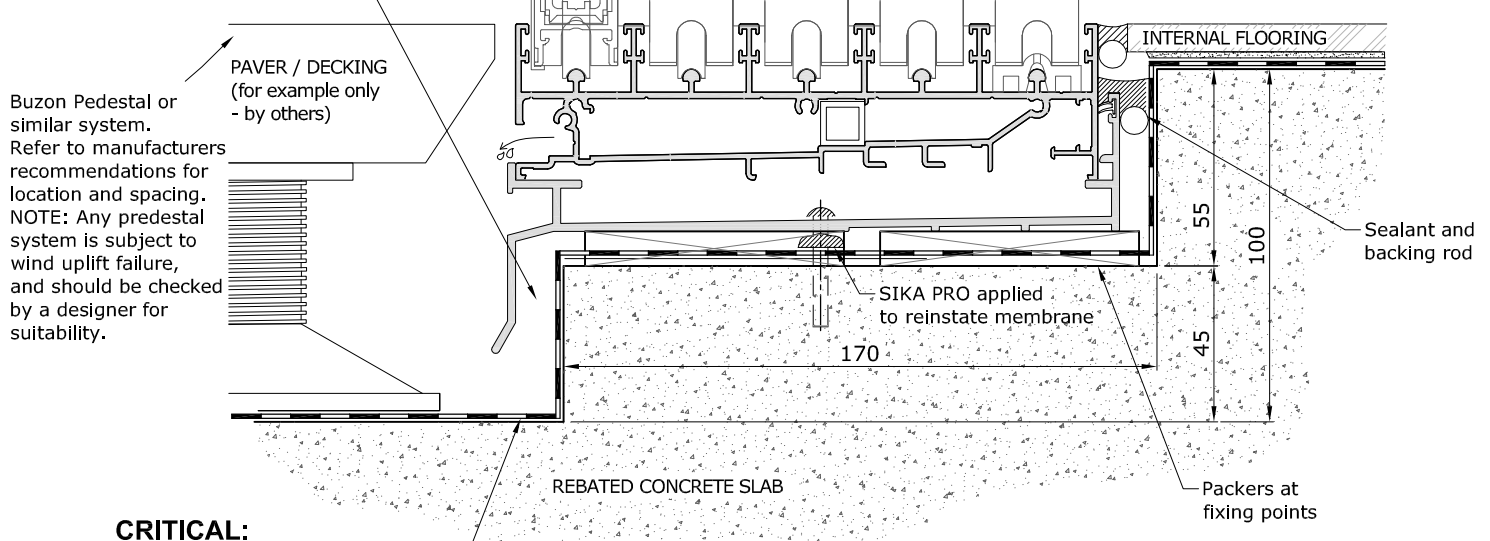

CRITICAL:

- Waterproof membrane (tanking) applied to opening (by others). * Prior to frame installation.

* IN ACCORDANCE WITH
AS:4654-2-2012

SILL

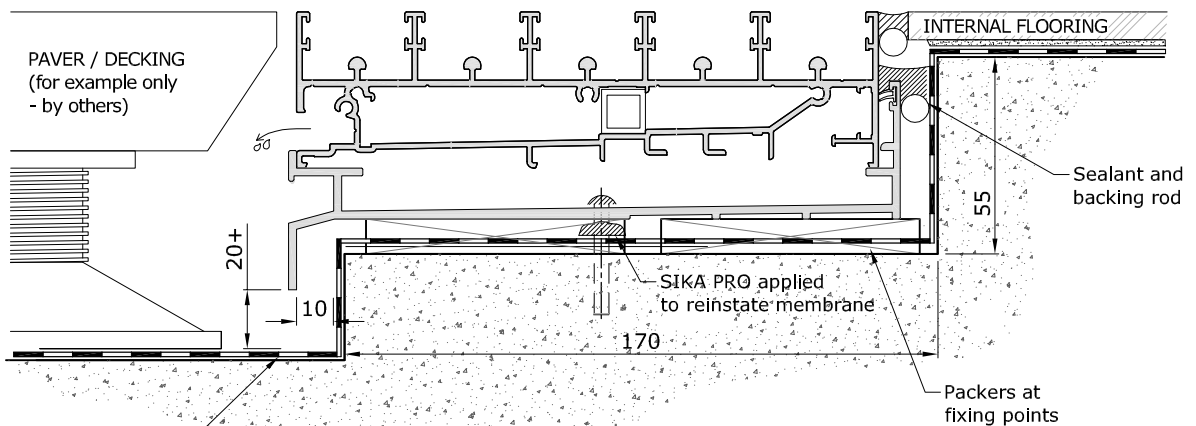

CRITICAL:

- Waterproof membrane (tanking) applied to opening (by others). * Prior to frame installation.

* IN ACCORDANCE WITH
AS:4654-2-2012

**ALTERNATE SILL
ARRANGEMENT**

- ▷ G.James considers the area under a sill to be a wet area, therefore the concrete must be waterproofed with a suitable tanking membrane. The front of this area is to be left open for drainage and pressure equalisation.
- ▷ Fixings shown are for illustration purposes only. All fixings to be assessed by a G.James Engineer to suit the design criteria of the project.
- ▷ Sill must be level side-to-side, front-to-back, and supported at fixing points.

**246 SERIES 5-TRACK SLIDING DOOR (168mm FRAME)
INSTALLATION WITH FLUSH SUMP DRAIN - HARD FIXED METHOD**

1 of 1

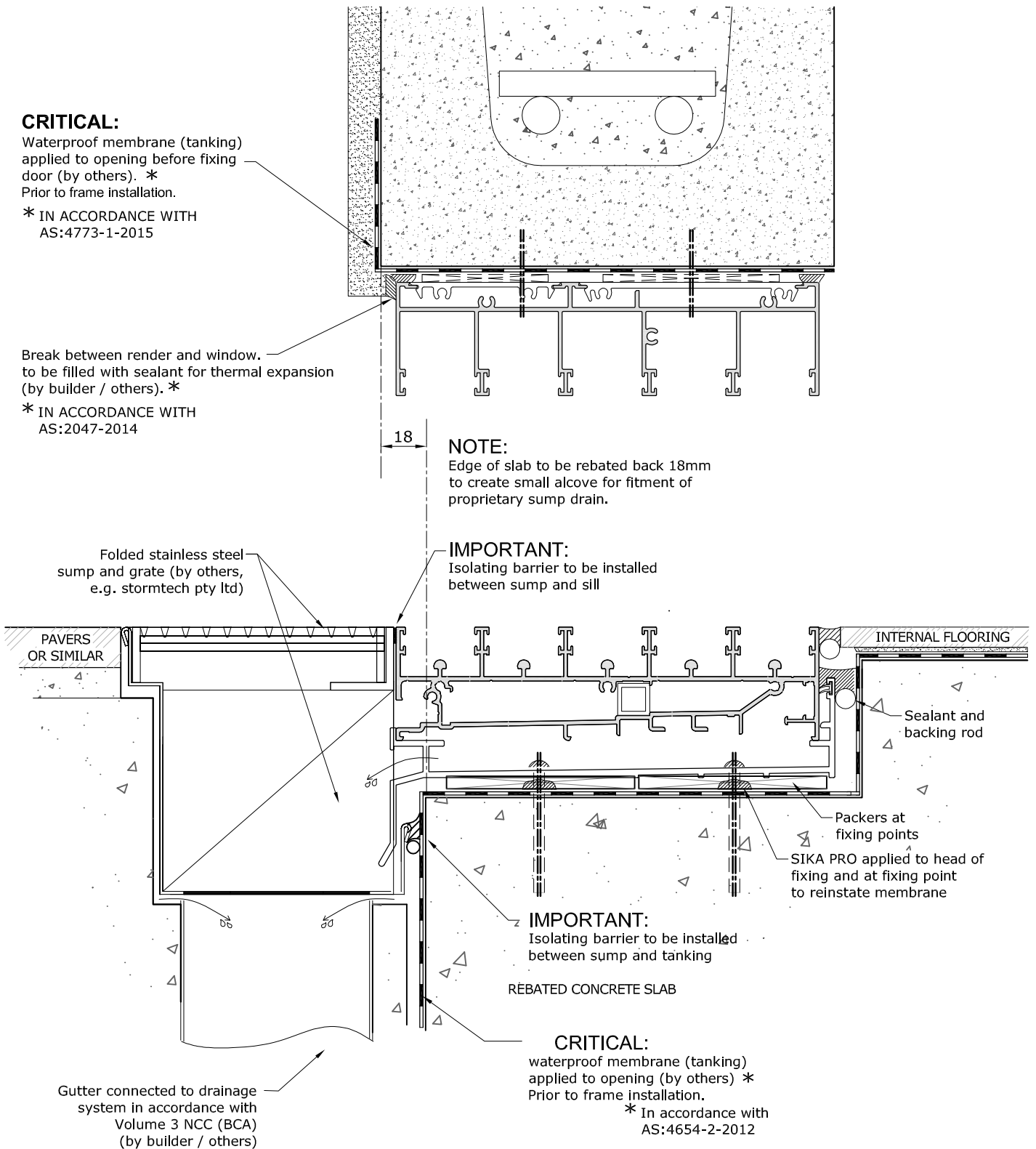

- ▷ Fixings shown are for illustration purposes only. All fixings to be assessed by a G.James Engineer to suit the design criteria of the project.
- ▷ Sill must be level side-to-side, front-to-back, and supported at fixing points.